

Kodak KLIC-8000 Rechargeable Battery

Effective: June 29, 2009

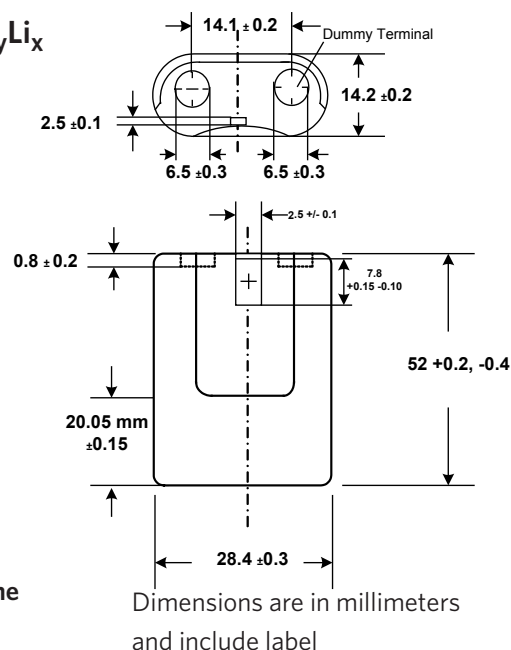

System:	Lithium Ion Battery
Reaction:	$\text{LiCoO}_2 + \text{C}_y \rightarrow \text{Li}_{1-x}\text{CoO}_2 + \text{C}_y\text{Li}_x$
Nominal Voltage:	3.7 Volts
Nominal Capacity:	1780 mAh/6.0 Wh
Minimum Capacity:	1600 mAh
Charging Condition:	180 mA
Max. Discharge:	3.2 A Continuous 4.8 A Intermittent
Temperature Ranges:	
Operating:	0°C to +50°C
Storage:	-20°C to +30°C
Charge Starting Ambient Temperature Range:	0°C to +40°C (Recommended) 0°C to +45°C (Tolerable)
Maximum Battery Temperature Range during Charge:	Charging should be terminated if the battery temperature $\geq 60^\circ\text{C}$.
Weight:	45 grams
Volume	20.5 cm³
Terminals:	Flat Contacts, one recessed
Jacket:	Plastic Housing/Film Label
Internal Impedance:	0.20 Ohms (typical)
Charging Cycles:	Up to 300
	Maximum life is achieved by shallow discharge and charge conditions



Note:

- 1) No added Mercury / 99.9999% Mercury Free — 2) No added Lead /99.999% Lead Free
- 3) No added Cadmium / 99.9999% Cadmium Free — 4) No added PFOS (Perfluorooctane sulfonates)
- 5) This battery complies with ANSI C18, IEC 60086, and EU Directive 2006/66/EC, 2006/122/EC
- 6) Batteries are NOT subject to European RoHS regulations
- 7) MSDS sheets are available on the Kodak website

The Data in this publication represents product tested under the conditions specified. They do not represent standards or specifications which must be met by Eastman Kodak Company. Company reserves the right to change and improve product characteristics at any time.

For more information, contact Eastman Kodak Company, 343 State Street, Rochester NY 14650-0811, Phone 1-800-242-2424 www.kodak.com/go/batteries

© Eastman Kodak Company, 2009

Kodak is a trademark.

